

FULLY REVERSIBLE PASSIVE WINDOW (OPUS HINGES) with ALU CLAD

NORWOOD SP.ZO.O.

Ul. Rataja 6, Rusocin
83-031 Łęgowo
+48 692 22 00
biuro@norwood.pl

| | | | | | |
|--------------------|-------------|---|-------------|-------------------|--|
| <i>Description</i> | | HTSOPA N109 FULLY REVERSIBLE WINDOW HEAD SECTION (48 mm glass) | | | |
| <i>Revis.</i> | <i>Date</i> | <i>Size</i> | <i>Drw.</i> | <i>Date</i> | |
| | | 1:1 | | 02.01.2018 | |
| <i>Verif.</i> | <i>Date</i> | <i>Drawing no.</i> | | | |
| | | HTSOPA - 48 - he - 01 | | | |

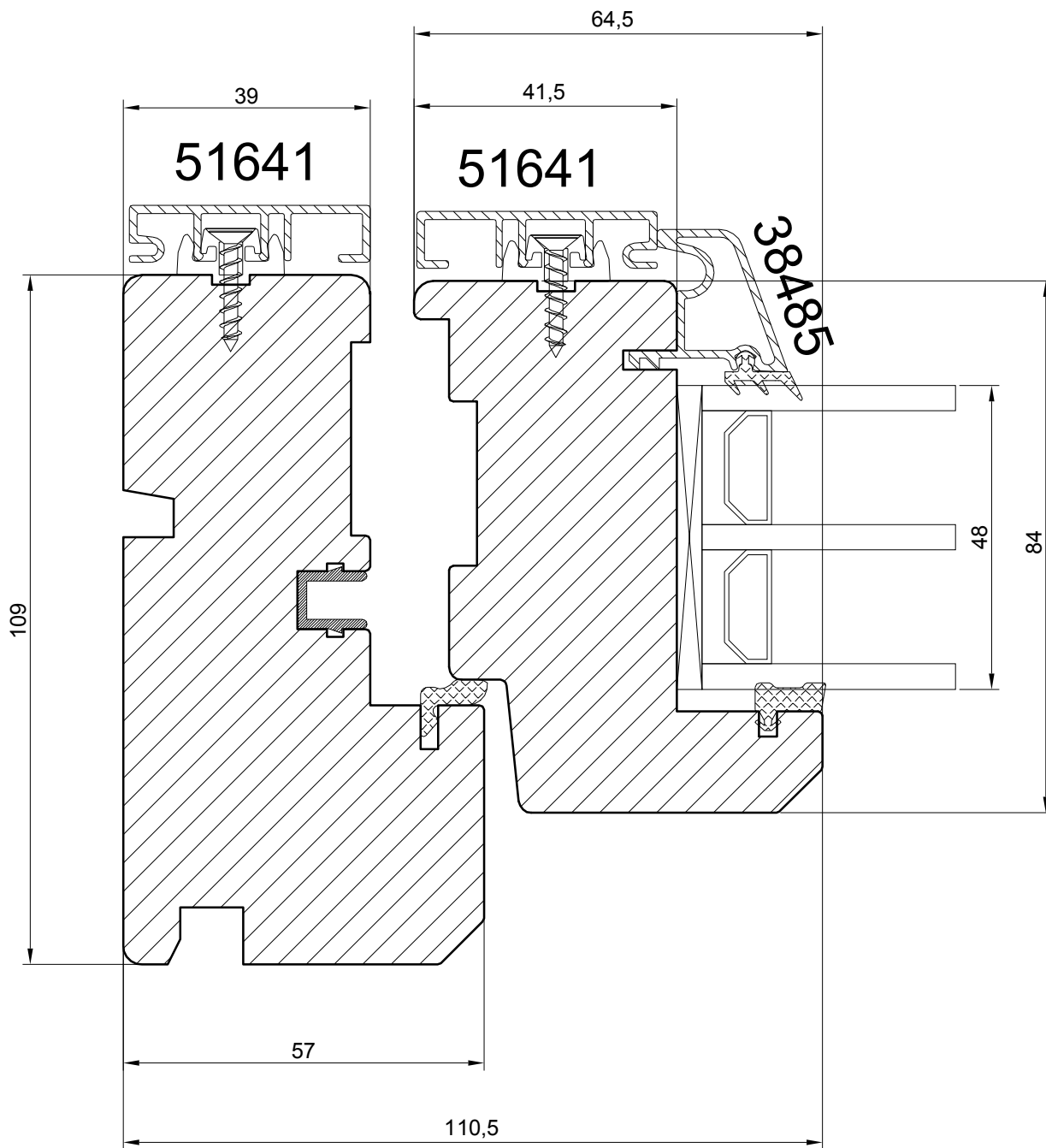

FULLY REVERSIBLE PASSIVE WINDOW (OPUS HINGES) with ALU CLAD

NORWOOD SP.ZO.O.

Ul. Rataja 6, Rusocin
83-031 Łęgowo
+48 692 22 00
biuro@norwood.pl

Description **HTSOPA N109 FULLY REVERSIBLE WINDOW
JAMB SECTION (48 mm glass)**

| | | | | | | |
|--------|------|-------------|-----|-----------------------|------|------------|
| Revis. | Date | Size | 1:1 | Drw. | Date | 02.01.2018 |
| Verif. | Date | Drawing no. | | HTSOPA - 48 - se - 01 | | |

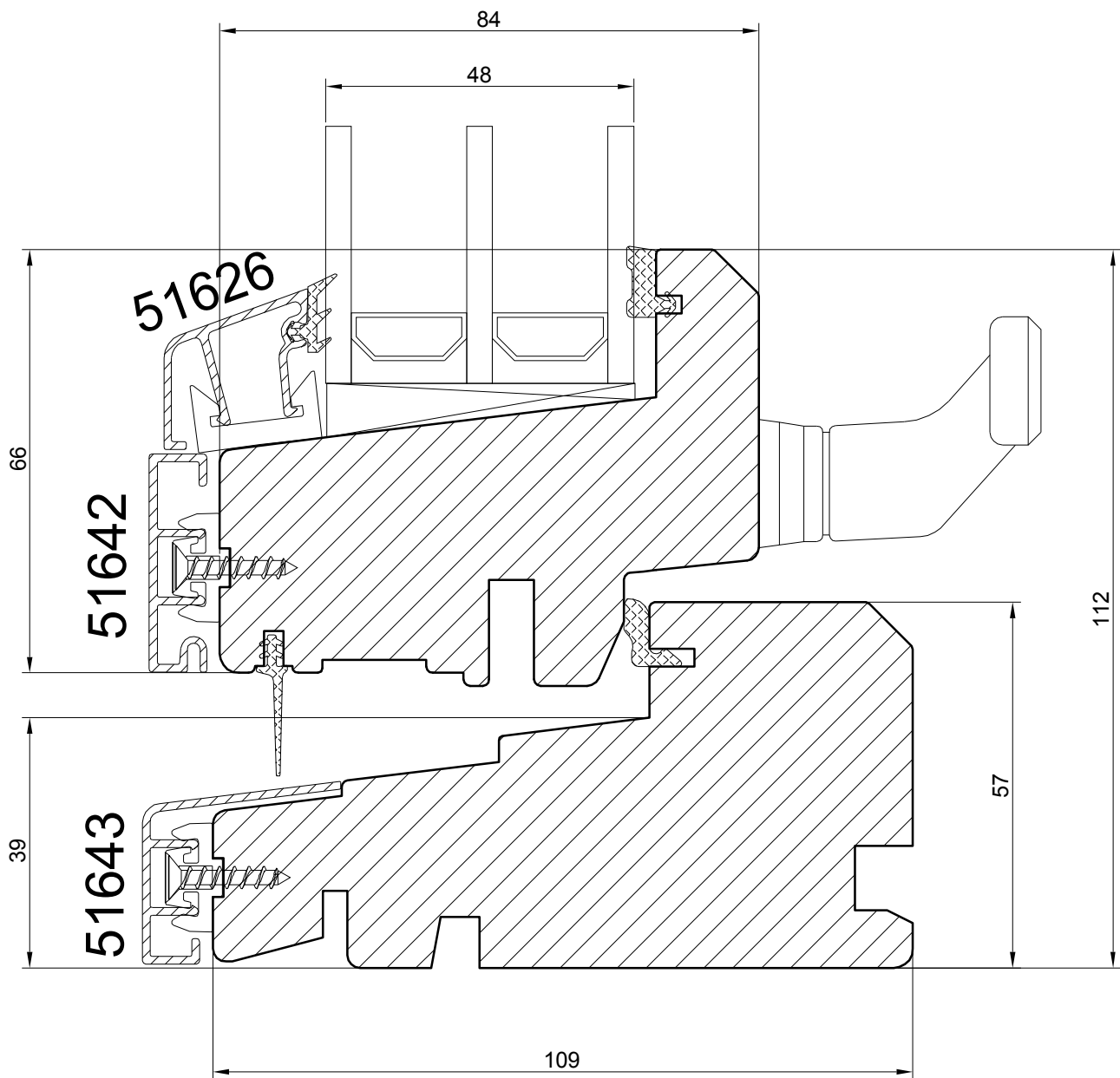

FULLY REVERSIBLE PASSIVE WINDOW (OPUS HINGES) with ALU CLAD

NORWOOD SP.ZO.O.

Ul. Rataja 6, Rusocin
83-031 Łęgowo
+48 692 22 00
biuro@norwood.pl

| | | | | | |
|--------------------|-------------|---|-------------|-------------------|--|
| <i>Description</i> | | HTSOPA N109 FULLY REVERSIBLE WINDOW SILL SECTION (48 mm glass) | | | |
| <i>Revis.</i> | <i>Date</i> | <i>Size</i> | <i>Drw.</i> | <i>Date</i> | |
| | | 1:1 | | 02.01.2018 | |
| <i>Verif.</i> | <i>Date</i> | <i>Drawing no.</i> | | | |
| | | HTSOPA - 48 - sl - 01 | | | |

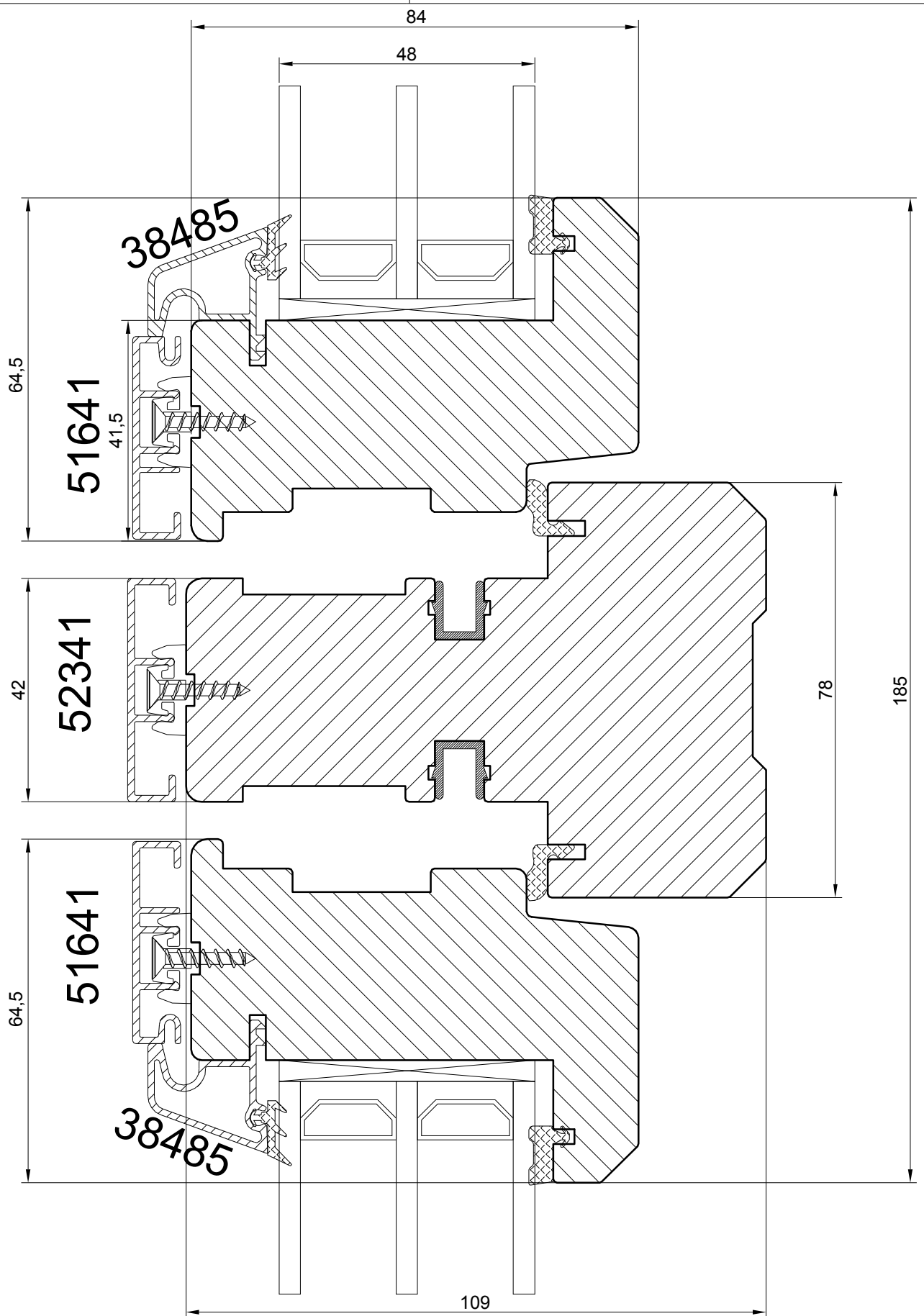

FULLY REVERSIBLE PASSIVE WINDOW (OPUS HINGES) with ALU CLAD

NORWOOD SP.ZO.O.

Ul. Rataja 6, Rusocin
83-031 Łęgowo
+48 692 22 00
biuro@norwood.pl

| | | | | | |
|--------------------|-------------|--|-------------|-------------------|--|
| <i>Description</i> | | HTSOPA N109 FULLY REVERSIBLE WINDOW MULLION (48 mm glass) | | | |
| <i>Revis.</i> | <i>Date</i> | <i>Size</i> | <i>Drw.</i> | <i>Date</i> | |
| | | 1:1 | | 02.01.2018 | |
| <i>Verif.</i> | <i>Date</i> | <i>Drawing no.</i> | | | |
| | | HTSOPA - 48 - ml - 01 | | | |

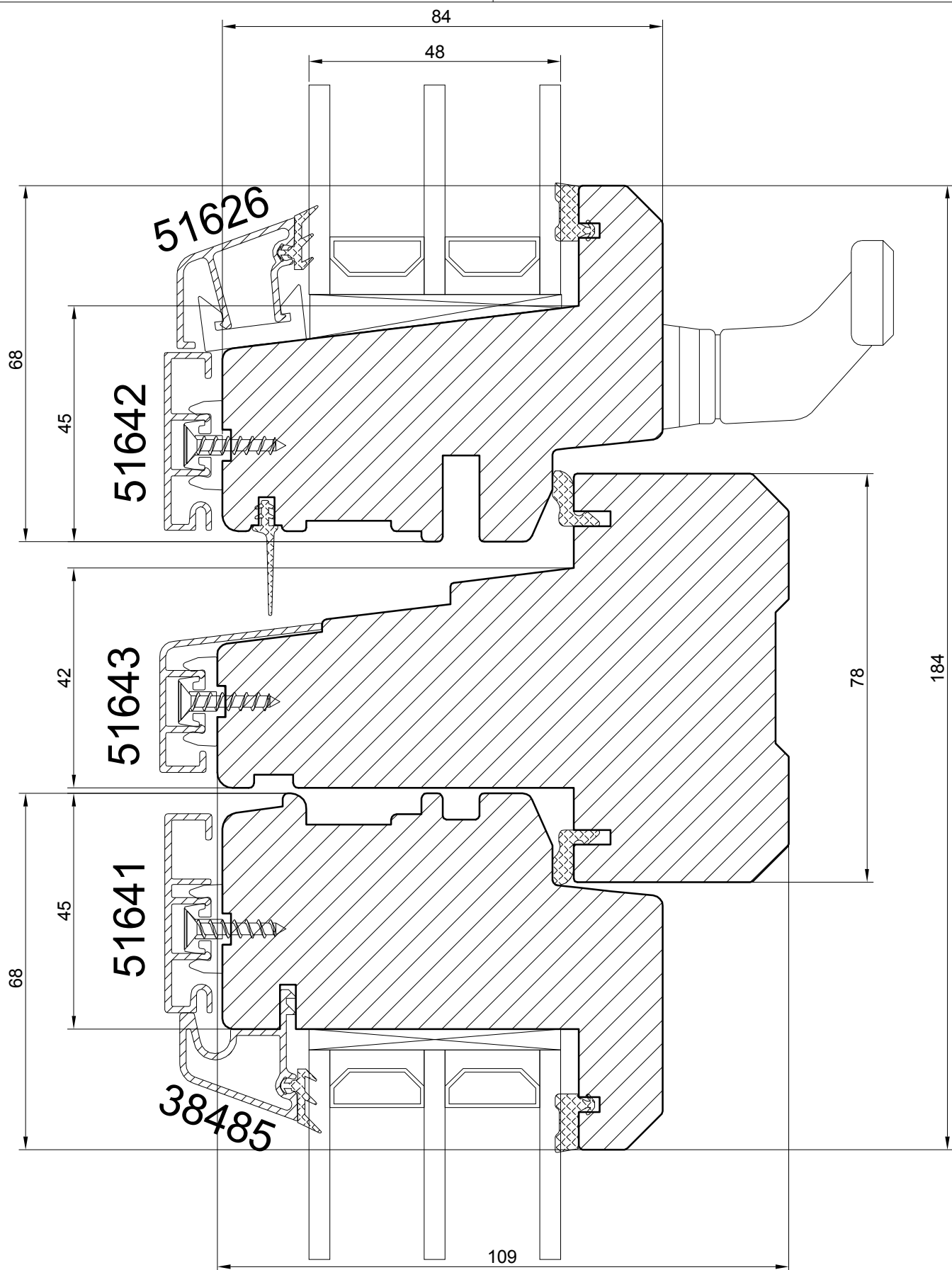

FULLY REVERSIBLE PASSIVE WINDOW (OPUS HINGES) with ALU CLAD

NORWOOD SP.ZO.O.

Ul. Rataja 6, Rusocin
83-031 Łęgowo
+48 692 22 00
biuro@norwood.pl

Description **HTSOPA N109 FULLY REVERSIBLE WINDOW
TRANSOM (48 mm glass)**

| | | | | | | |
|--------|------|-------------|-----------------------|------|------|------------|
| Revis. | Date | Size | 1:1 | Drw. | Date | 02.01.2018 |
| Verif. | Date | Drawing no. | HTSOPA - 48 - ts - 01 | | | |

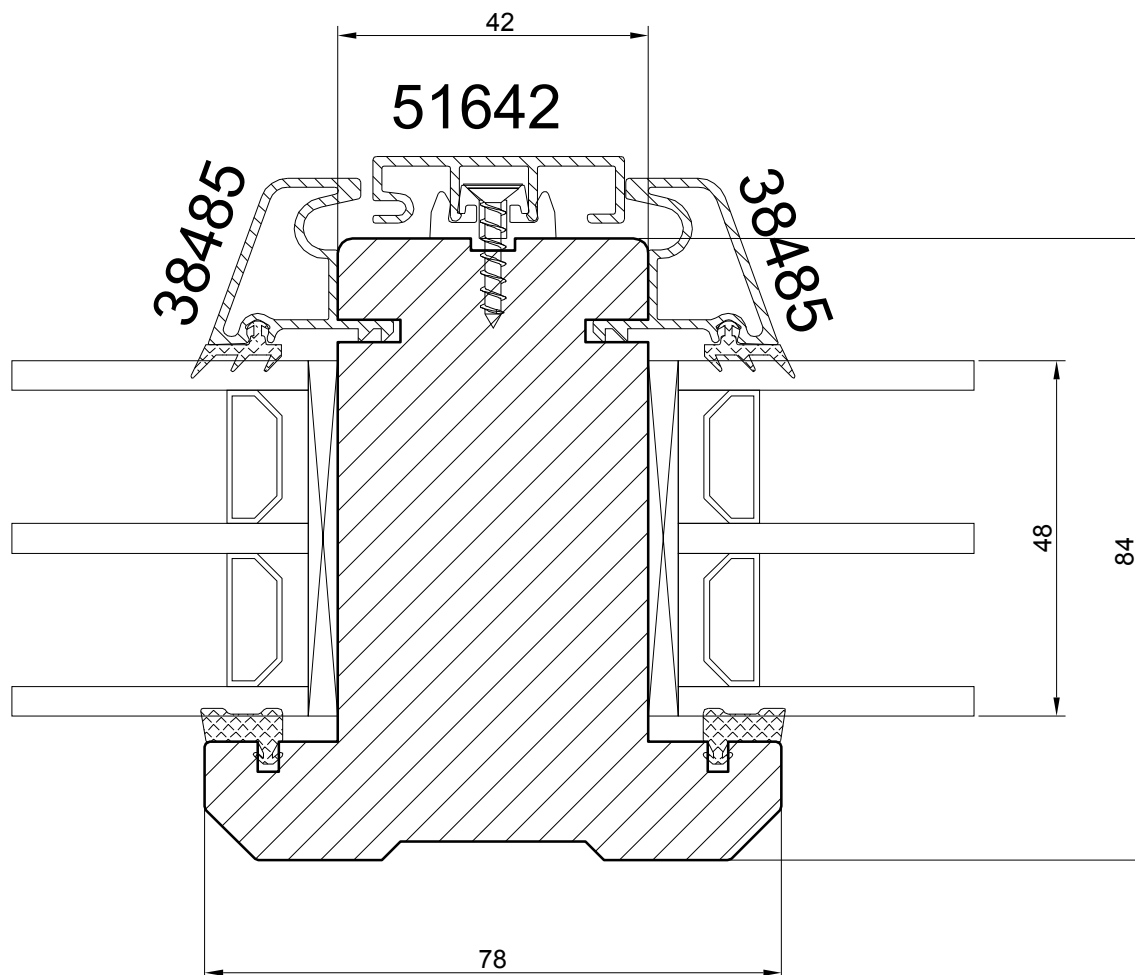

FULLY REVERSIBLE PASSIVE WINDOW (OPUS HINGES) with ALU CLAD

NORWOOD SP.ZO.O.

Ul. Rataja 6, Rusocin
83-031 Łęgowo
+48 692 22 00
biuro@norwood.pl

Description HTSOPA N109 FULLY REVERSIBLE WINDOW

VERTICAL BAR (48 mm glass)

| | | | | |
|---------------|-------------|-------------------|-------------|------------------------|
| <i>Revis.</i> | <i>Date</i> | <i>Size</i> 1 : 1 | <i>Drw.</i> | <i>Date</i> 02.01.2018 |
|---------------|-------------|-------------------|-------------|------------------------|

| | | |
|---------------|-------------|--|
| <i>Verif.</i> | <i>Date</i> | <i>Drawing no.</i> HTSOPA - 48 - vs78 - 01 |
|---------------|-------------|--|

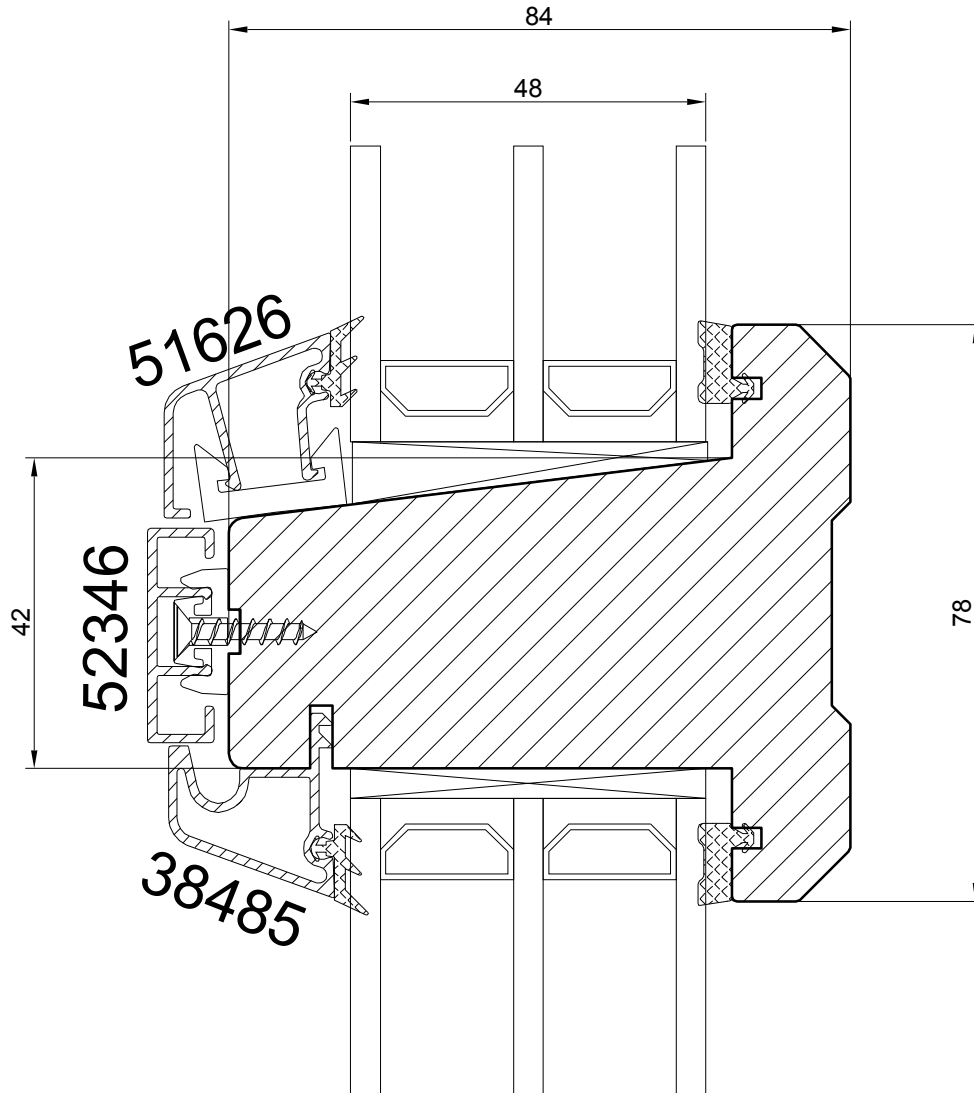

FULLY REVERSIBLE PASSIVE WINDOW (OPUS HINGES) with ALU CLAD

NORWOOD SP.ZO.O.

Ul. Rataja 6, Rusocin
83-031 Łęgowo
+48 692 22 00
biuro@norwood.pl

| | | | | | |
|--------------------|-------------|---|-------------|-------------------|--|
| <i>Description</i> | | HTSOPA N109 FULLY REVERSIBLE WINDOW HORIZONTAL BAR (48 mm glass) | | | |
| <i>Revis.</i> | <i>Date</i> | <i>Size</i> | <i>Drw.</i> | <i>Date</i> | |
| | | 1:1 | | 02.01.2018 | |
| <i>Verif.</i> | <i>Date</i> | <i>Drawing no.</i> | | | |
| | | HTSOPA - 48 - hs78 - 01 | | | |