

FULLY REVERSIBLE PASSIVE WINDOW with ALU CLAD

NORWOOD SP.ZO.O.

Ul. Rataja 6, Rusocin
 83-031 Łęgowo
 +48 692 22 00
 biuro@norwood.pl

<i>Description</i>		HTSPA N109 FULLY REVERSIBLE WINDOW HEAD SECTION (48 mm glass)			
<i>Revis.</i>	<i>Date</i>	<i>Size</i>	<i>Drw.</i>	<i>Date</i>	
		1:1		02.01.2018	
<i>Verif.</i>	<i>Date</i>	<i>Drawing no.</i>			
		HTSPA - 48 - he - 01			

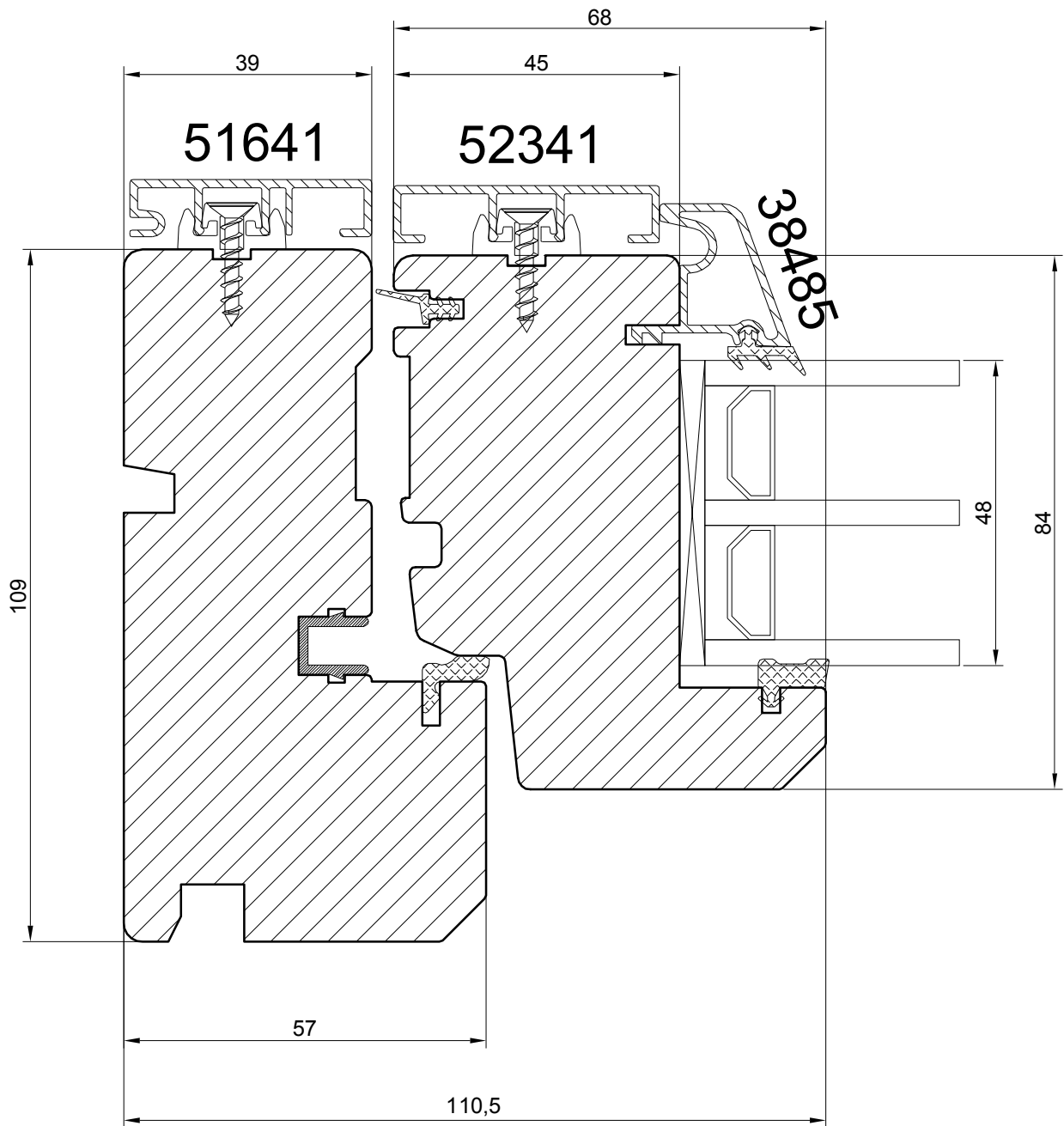

FULLY REVERSIBLE PASSIVE WINDOW with ALU CLAD

NORWOOD SP.ZO.O.

Ul. Rataja 6, Rusocin
83-031 Łęgowo
+48 692 22 00
biuro@norwood.pl

<i>Description</i>		HTSPA N109 FULLY REVERSIBLE WINDOW JAMB SECTION (48 mm glass)			
<i>Revis.</i>	<i>Date</i>	<i>Size</i>	<i>Drw.</i>	<i>Date</i>	
		1:1		02.01.2018	
<i>Verif.</i>	<i>Date</i>	<i>Drawing no.</i>			
		HTSPA - 48 - se - 01			

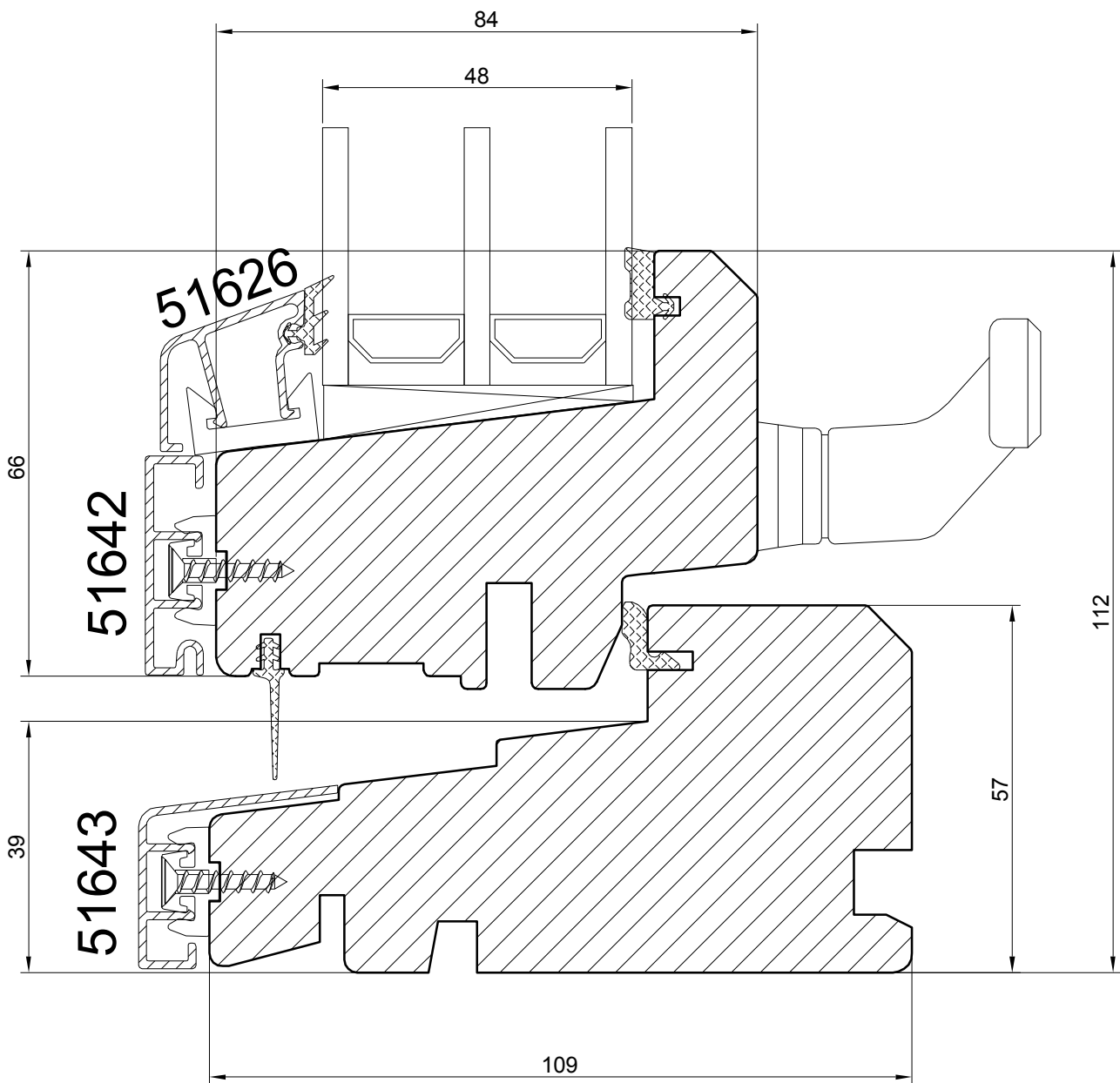

FULLY REVERSIBLE PASSIVE WINDOW with ALU CLAD

NORWOOD SP.ZO.O.

Ul. Rataja 6, Rusocin
83-031 Łęgowo
+48 692 22 00
biuro@norwood.pl

<i>Description</i>		HTSPA N109 FULLY REVERSIBLE WINDOW SILL SECTION (48 mm glass)			
<i>Revis.</i>	<i>Date</i>	<i>Size</i>	<i>Drw.</i>	<i>Date</i>	
		1 : 1		02.01.2018	
<i>Verif.</i>	<i>Date</i>	<i>Drawing no.</i>			
		HTSPA - 48 - sl - 01			

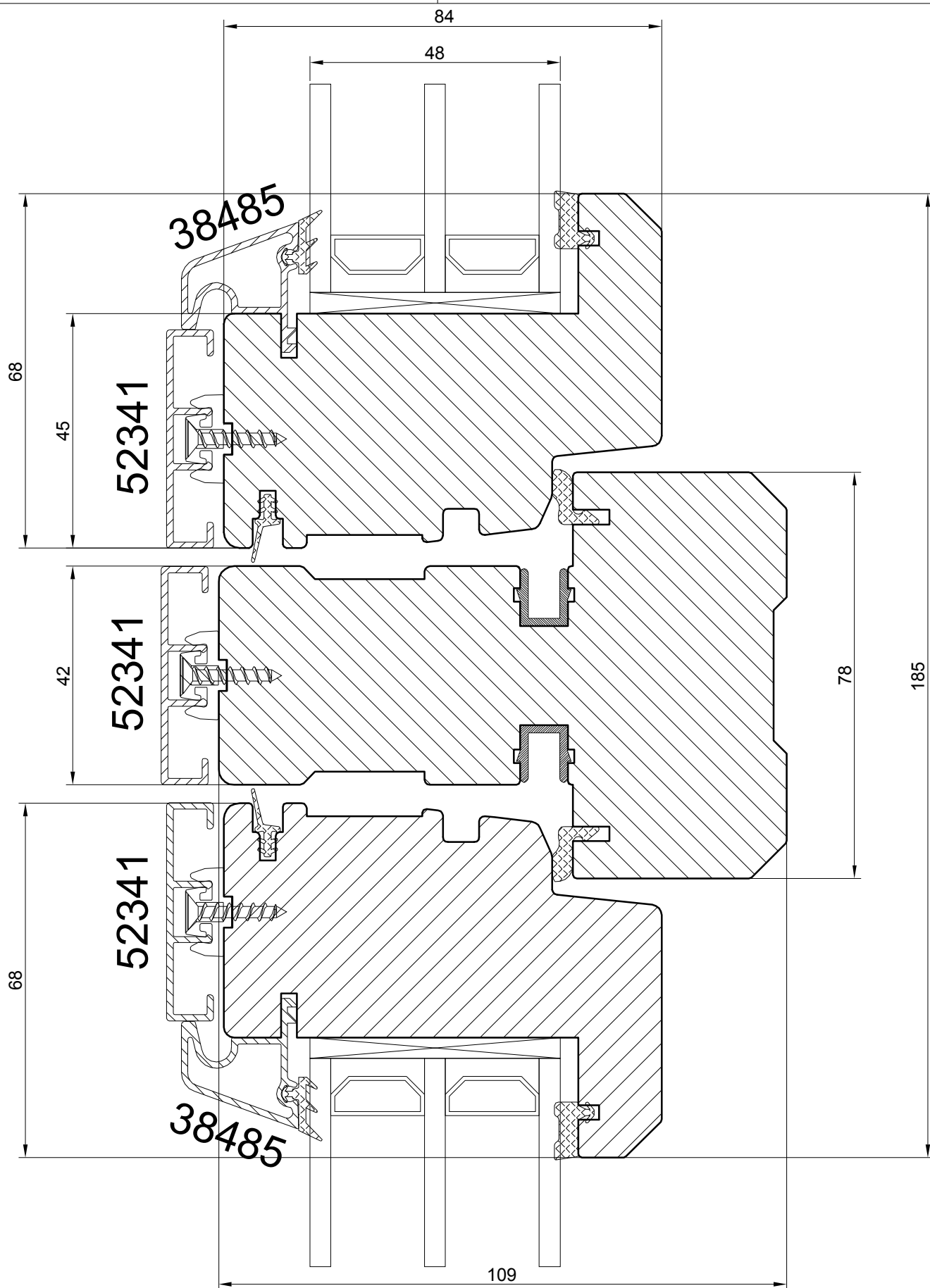

FULLY REVERSIBLE PASSIVE WINDOW with ALU CLAD

NORWOOD SP.ZO.O.

Ul. Rataja 6, Rusocin
83-031 Łęgowo
+48 692 22 00
biuro@norwood.pl

Description **HTSPA N109 FULLY REVERSIBLE WINDOW
MULLION (48 mm glass)**

Revis.	Date	Size	1:1	Drw.	Date	02.01.2018
Verif.	Date	Drawing no. HTSPA - 48 - ml - 01				

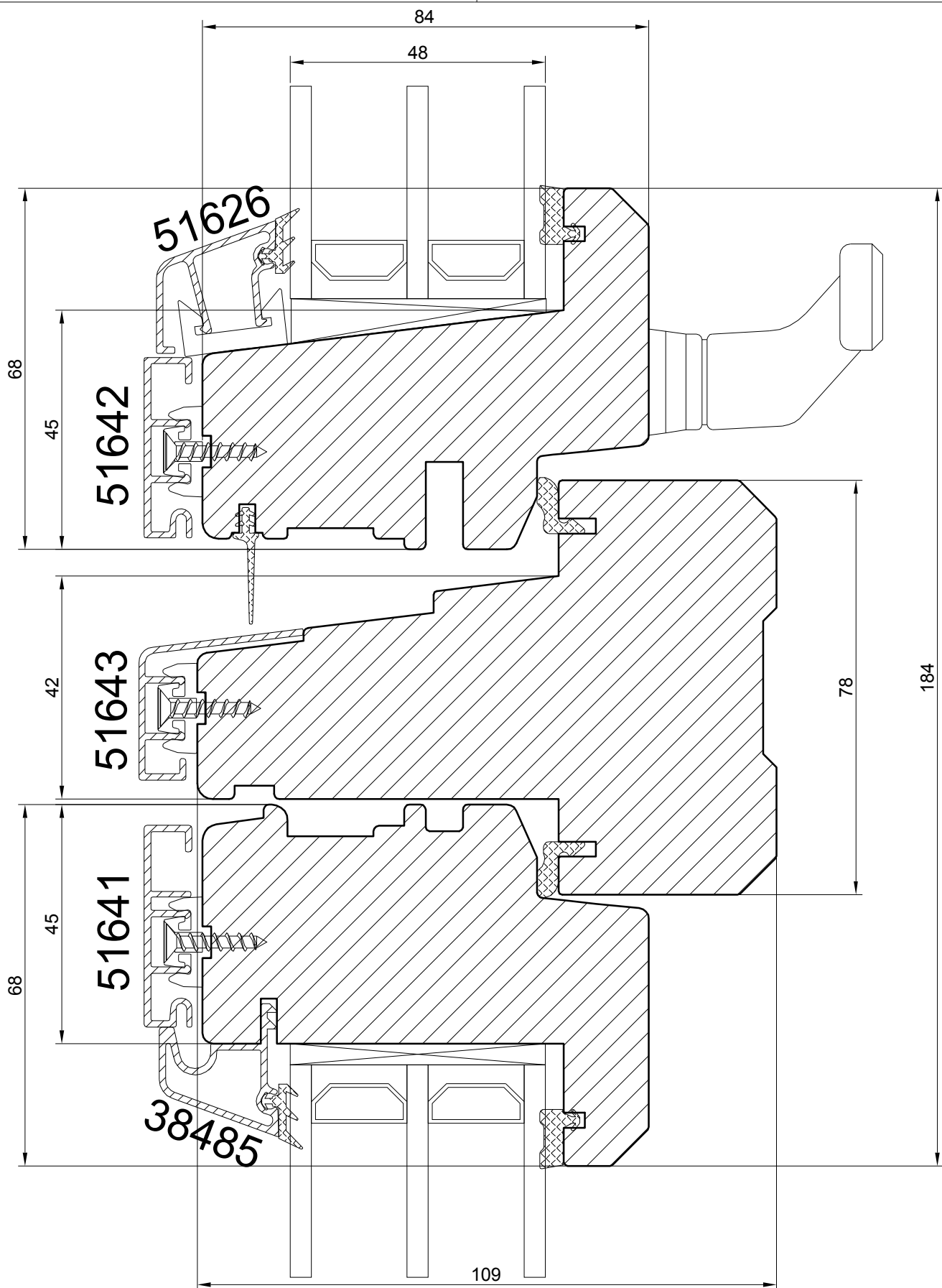

FULLY REVERSIBLE PASSIVE WINDOW with ALU CLAD

NORWOOD SP.ZO.O.

Ul. Rataja 6, Rusocin
83-031 Łęgowo
+48 692 22 00
biuro@norwood.pl

Description **HTSPA N109 FULLY REVERSIBLE WINDOW
TRANSOM (48 mm glass)**

Revis.	Date	Size	1:1	Drw.	Date	02.01.2018
Verif.	Date	Drawing no. HTSPA - 48 - ts - 01				

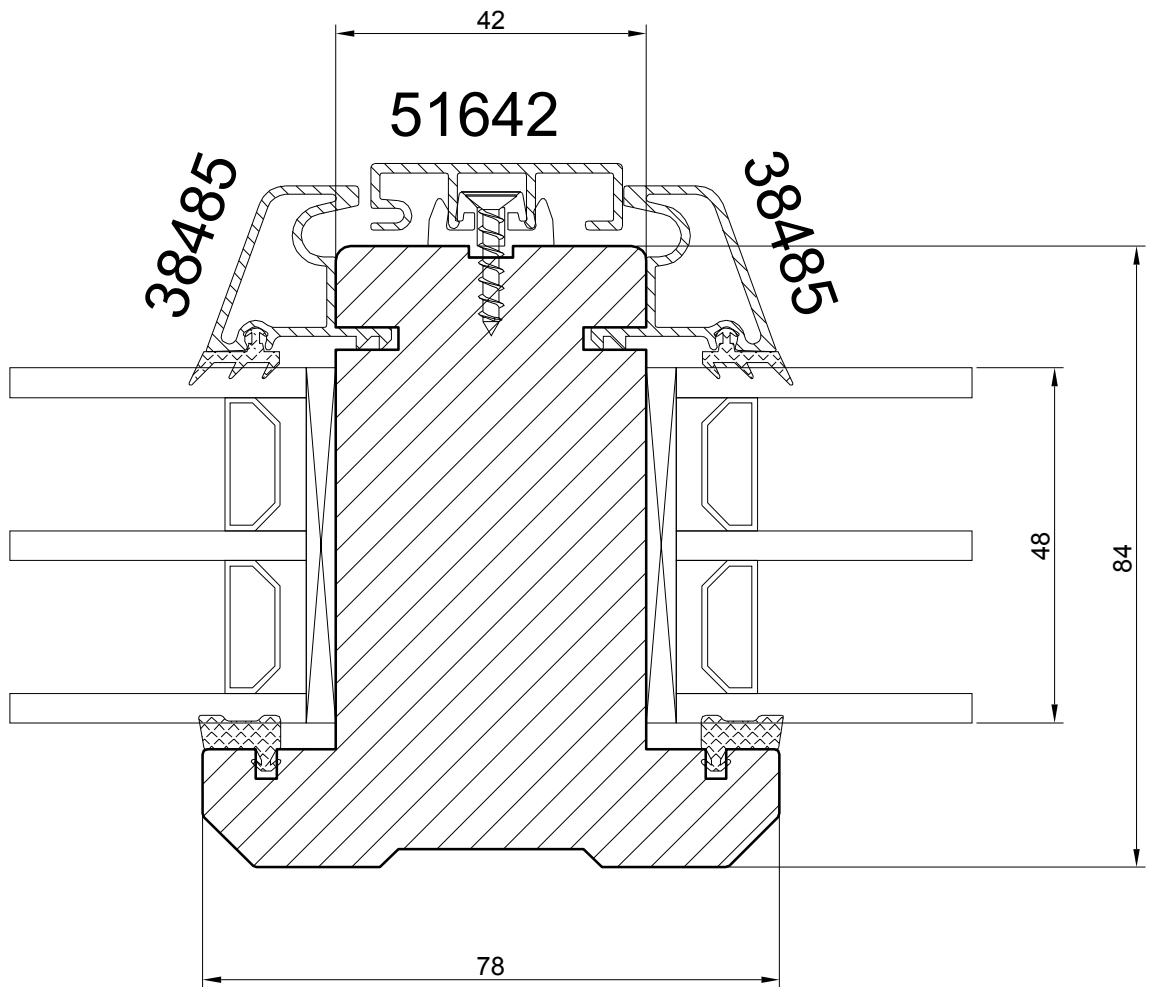

FULLY REVERSIBLE PASSIVE WINDOW with ALU CLAD

NORWOOD SP.ZO.O.

Ul. Rataja 6, Rusocin
83-031 Łęgowo
+48 692 22 00
biuro@norwood.pl

<i>Description</i>		HTSPA N109 FULLY REVERSIBLE WINDOW			
		VERTICAL BAR (48 mm glass)			
<i>Revis.</i>	<i>Date</i>	<i>Size</i>	<i>Drw.</i>	<i>Date</i>	
		1:1		02.01.2018	
<i>Verif.</i>	<i>Date</i>	<i>Drawing no.</i>			
		HTSPA - 48 - vs - 01			

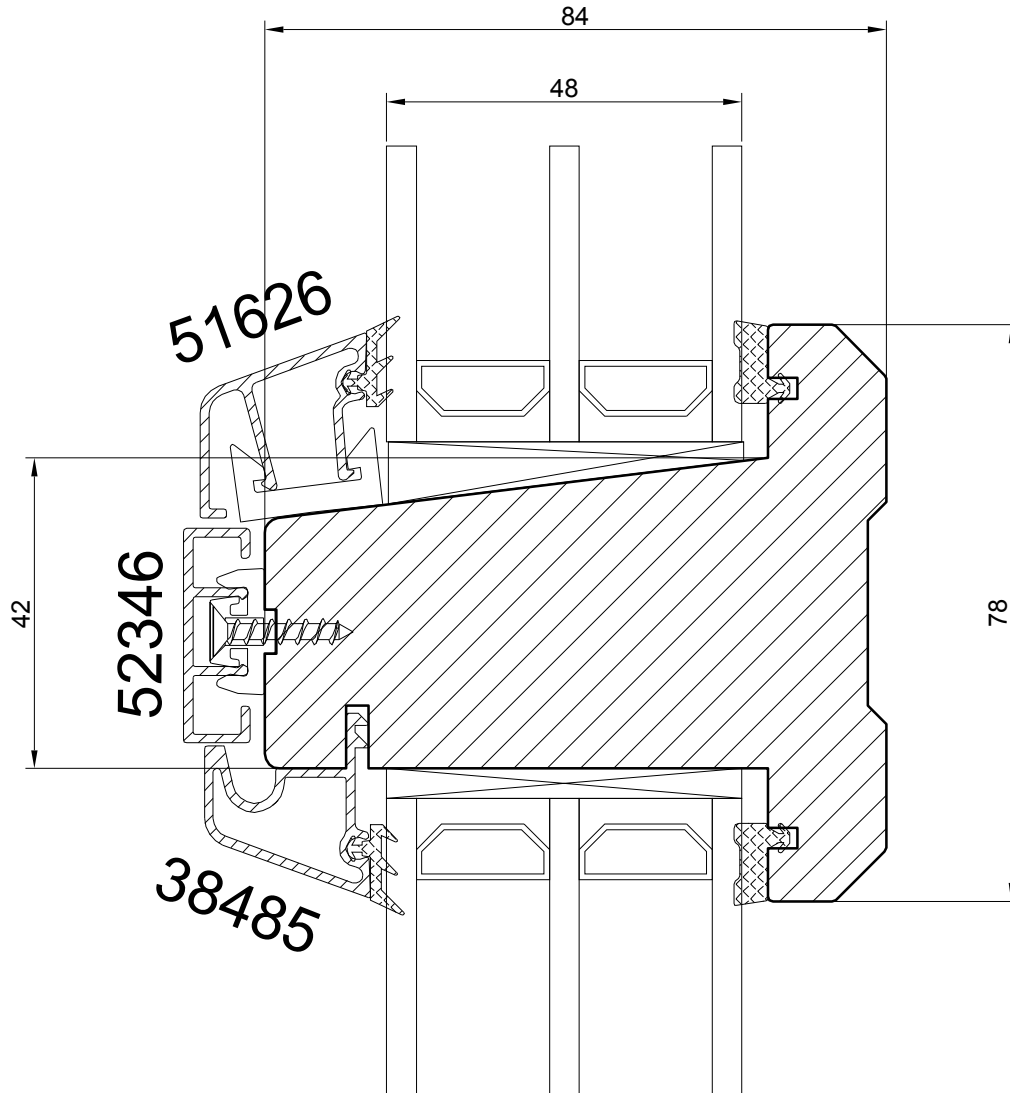

FULLY REVERSIBLE PASSIVE WINDOW with ALU CLAD

NORWOOD SP.ZO.O.

Ul. Rataja 6, Rusocin
83-031 Łęgowo
+48 692 22 00
biuro@norwood.pl

<i>Description</i>		HTSPA N109 FULLY REVERSIBLE WINDOW HORIZONTAL BAR (48 mm glass)			
<i>Revis.</i>	<i>Date</i>	<i>Size</i>	<i>Drw.</i>	<i>Date</i>	
		1:1		02.01.2018	
<i>Verif.</i>	<i>Date</i>	<i>Drawing no.</i>			
		HTSPA - 48 - hs - 01			